

# The Role Concept of the Instance List

The Designer provides you with a role-based authorization concept (similar to the [role-based authorization concept to run applications](#)) that allows you to define which user is authorized to see the instance list of the respective process.

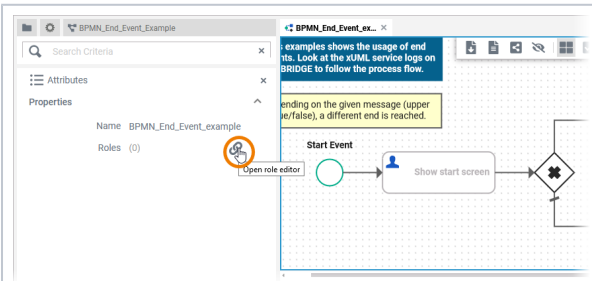

Each process has its own instance list. To access the role editor, select the respective BPMN model of your service on the diagram pane and switch to the Attributes panel.

Click the icon next to **Roles**.

The Role Editor dialog box is shown. It has a title bar 'Role Editor' and a 'Role' section. Below this, there is a list of roles: 'acme\_manager', 'acme\_c', and 'acme\_ceo'. The 'acme\_ceo' role is highlighted with a blue background. At the bottom of the dialog, there are four buttons: 'Add', 'New Role', 'Save', and 'Cancel'.

The role editor opens. The dialog initially contains an empty line to enter a role.

The handling of the role editor is described in detail on [Modeling Roles](#). There is one difference to the role editor of the instance list: Here, you have no radio buttons to assign different rights to roles.

**i** Information

## On this Page:

- [The Role Concept in the Executed Application](#)

## Related Pages:

- [PAS Designer User Guide](#)
  - [BPMN Model](#)
- [Running Designer Applications](#)
  - [Creating a Process Instance](#)
  - [Showing the Instance List](#)
- [PAS Designer Developer Guide](#)
  - [Data Table](#)

e  
a  
s  
s  
i  
g  
n  
e  
d  
,  
t  
h  
e  
i  
n  
s  
t  
a  
n  
c  
e  
l  
i  
s  
t  
i  
s  
a  
v  
a  
i  
l  
a  
b  
l  
e  
f  
o  
r  
a  
l  
l  
u  
s  
e  
r  
s  
a  
n  
d  
a  
c  
c  
o  
r  
r  
e  
s  
p  
o  
n  
d  
i  
n  
g  
n  
o  
t  
e  
i  
s  
d  
i  
s  
p  
l  
a  
y  
e  
d.

# The Role Concept in the Executed Application

Our example illustrates the usage of roles in the instance list. Our example users David Stringer and Jane Marple have the following roles assigned:

Name	Role
David Stringer	ACME Employee
Jane Marple	ACME Manager

The following roles have the permission to see the instance list:

Role Editor

Role

acme\_ceo

acme\_manager

Add

New Role

Save

Cancel

- ACME CEO (acme\_ceo)
- ACME Manager (acme\_manager)

V

Scheer IPAS

BPMN\_End\_Event

en



Jane Marple

ACME Corp

Applications

Process

BPMN\_End\_Event\_example

Jane Marple has the role **ACME Manager** and thus has the necessary rights to see the instance list. In the application, she will see icon  in addition to icon  (see [Creating a Process Instance](#)) when hovering over the service name.

V

Scheer IPAS

BPMN\_End\_Event\_example

en

Jane Marple  
ACME Corp.

3 All

Instances

+

Current Task

Instance Id

Show\_start\_screen

0000002e638aaaa80004d20bf0700d5aa9f3a

Show\_start\_screen

0000003b6452aa920002f9c5e7fc7002ea4e99a

Show\_start\_screen

0000009b45327be70002f9c5e7fc7004d33fe0e

3

After selecting icon, the instance list opens and all open instances are displayed.

V

Scheer IPAS

BPMN\_End\_Event

en

David Stringer  
ACME Corp.

Applications

Process

BPMN\_End\_Event\_example

+

David Stringer has the role **ACME Employee** and thus has not the necessary rights to see the instance list. In the application, he will only see icon to create a new process instance. For him, icon is not displayed and so he cannot access the instance list.